

Production Worksheet

Wilcom EmbroideryStudio - Designing

Design: **FBFC1754**

Title:

Stitches: 4,358
Height: 2.80 in
Width: 2.80 in
Colors: 2
Colorway: Colorway 1
Zoom: 1.83

BFC Creations

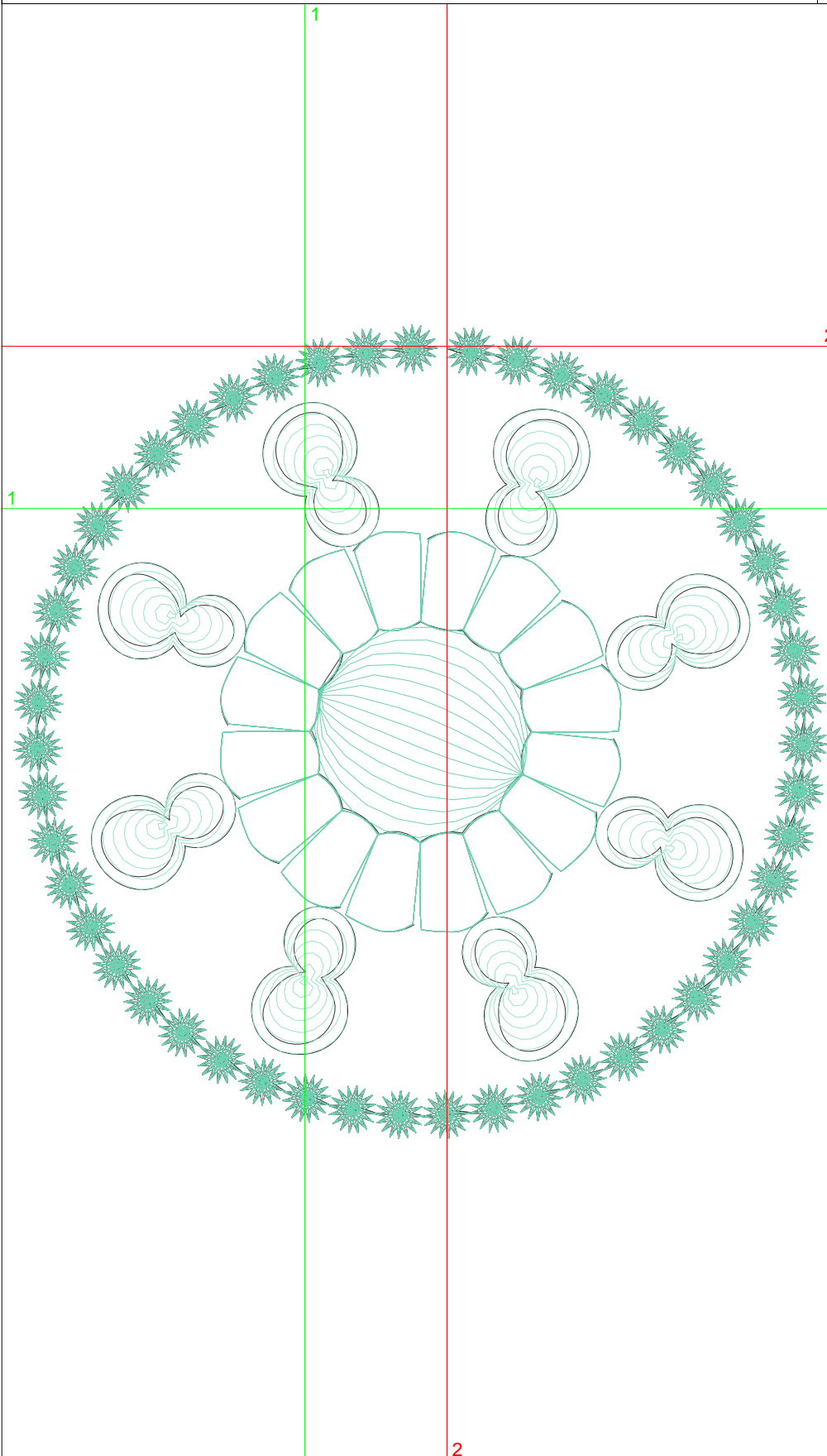

Machine format: Tajima
Color changes: 1
Stops: 2
Trims: 10
Appliqués: 0
Left: 25.4 mm
Right: 45.7 mm
Up: 16.0 mm
Down: 55.1 mm
EndX: 0.49 in
EndY: 0.56 in
Area: 7.84 in²
Max stitch: 6.5 mm
Min stitch: 0.3 mm
Max jump: 6.5 mm
Thread chart: BFC Poly
Total thread: 72.26ft
Total bobbin: 25.49ft

Stop Sequence:

#	Color	St.	Code	Name	Chart
1.	1,385	3511	PALE	Teal	BFC Poly
2.	2,971	3520	MD	Teal	BFC Poly

Thread usage: 71.60ft

N#	Color	Name	Length
3.	3511	PALE Teal	14.28ft
2.	3520	MD Teal	57.31ft